

**VI422113**  
**Vario flex induction cooktop 400 series**  
**Stainless steel frame**  
**Width 38 cm**

Flex function for combining the rectangular cooking areas  
 Free positioning of cookware inside combined cooking areas  
 Frying sensor function for temperature control in pans  
 Easy control of all functions with bicoloured display  
 Solid stainless steel control knob  
 Precision crafting of 3 mm stainless steel  
 For surface mounting with a visible edge or for flush mounting  
 Can be combined perfectly with other Vario appliances of the 400 series

**Cooking zones**  
 2 flex induction cooking areas 19x24 cm (2200 W, with booster 3700 W), linked together 38x24 cm (3300 W, with booster 3700 W).

**Handling**  
 Control knobs with illuminated ring, cooking zone and output level markings.  
 Electronic power control in 12 output levels.  
 User friendly control with bicoloured display (white / orange).

**Features**  
 Flex function for rectangular cooking areas.  
 Frying sensor function.  
 Booster function.  
 Stopwatch.  
 Short-term timer.  
 Options menu.  
 Cooktop-based ventilation control (with suitable hood).  
 Home network integration for digital services (Home Connect) wireless via WiFi.  
 The use of the Home Connect functionality depends on the Home Connect services, which are not available in every country. For further information please check: home-connect.com.

**Safety**  
 Safety shut-off.

**Planning notes**  
 Depending on the type of installation (surface-mounted or flush-mounted), the specific location of the cut-out and the knob positions may vary.  
 The horizontal positioning of the knobs may be aligned with the specific cooking areas.  
 The drawing "Installation of the control knob" must be observed if the panel is more than 23 mm thick (there must be a recess at the rear).  
 If combining several Vario appliances of the 400 series, a connection strip VA 420 must be placed between the appliances. Depending on the type of installation, the corresponding connection strip must be provided.  
 The bearing capacity and stability, in the case of thin worktops in particular, must be supported using suitable substructures. Take into account the appliance weight and additional loads.  
 Additional instructions for flush mounting:

**Characteristics**  
**Product name/family**  
 Vario/Domino cooking zone cera  
**Built-in / Free-standing**  
 Built-in  
**Energy input**  
 Electric  
**Total number of positions that can be used at the same time**  
 2  
**Required niche size for installation (HxWxD)**  
 57 x 360 x 490-500  
**Width of the appliance**  
 380  
**Dimensions**  
 57 x 380 x 520  
**Dimensions of the packed product (HxWxD) (mm)**  
 120 x 580 x 600  
**Net weight (kg)**  
 9.871  
**Gross weight (kg)**  
 10.9  
**Residual heat indicator**  
**Location of control panel**  
 External control  
**Basic surface material**  
 Ceramic  
**Color of surface**  
 Black, Stainless steel  
**Color of frame**  
 Stainless steel  
**Approval certificates**  
 AENOR, CE  
**Length electrical supply cord (cm)**  
 150

**Consumption and connection features**  
**Connection Rating (W)**  
 3700  
**Gas connection rating (W)**  
**Current (A)**  
 16  
**Voltage (V)**  
 220-240  
**Frequency (Hz)**  
 50; 60  
**2020-10-23**  
 Page 1

Installation is possible in worktops made of stone, synthetics or solid wood. Heat resistance and watertight sealing of the cut edges must be observed. Concerning other materials please consult the worktop manufacturer.  
 The groove must be continuous and even, so that uniform placing of the appliance on the gasket is ensured. Do not use discontinuous lining.  
 The joint width may vary due to size tolerances of the combinations and of the worktop cut-out.  
 If installing several appliances in individual cut-outs allow for a division bar of minimum 50 mm between the individual cut-outs.  
 Operates with magnetic (induction) iron pots and pans only. For an optimal heat distribution, the use of sandwich bottom cookware is recommended.  
 Appliance can be snapped into the worktop from above.  
 Appliance weight: approx. 10. kg

**Connection**  
 Total connected load 3.7 KW.  
 Connecting cable 1.5 m without plug.  
 Power consumption standby/display off 0.5 W.  
 Power consumption standby/network 1.4 W.  
 Please check the user manual for how to switch off the WiFi module.

**Color Variants**  
**VI422113**  
**Stainless steel frame**  
**Width 38 cm**

**Installation Accessories**  
**VA420000**  
 Connection strip for combination with other Vario appliances of the 400 series for flush mounting  
**VA420010**  
 Connection strip for combination with other Vario appliances of the 400 series for surface mounting

Installation of the control knob; flush installation

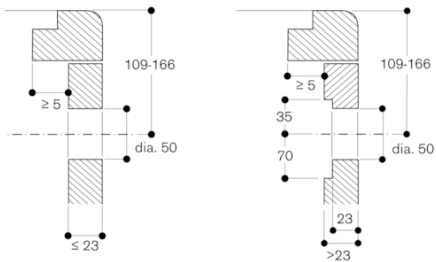

measurements in mm

Installation of the control knob; surface mounting

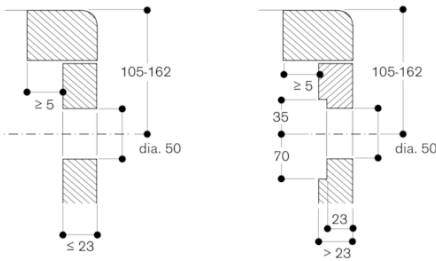

measurements in mm

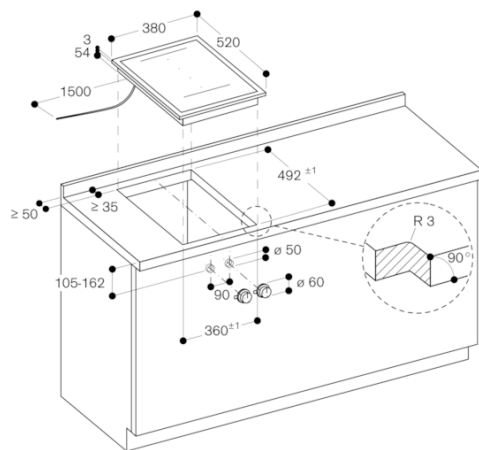

measurements in mm

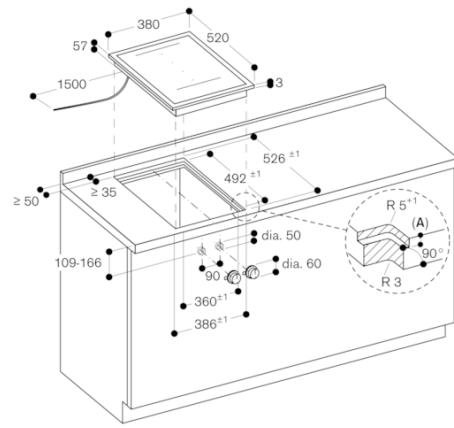

A: 3.5<sup>±0.5</sup>  
 measurements in mm

Longitudinal section

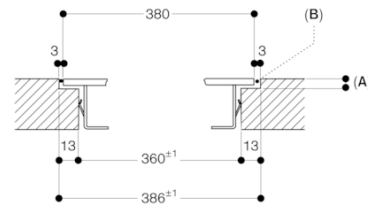

A: 3.5<sup>±0.5</sup>  
 B: Fill with silicone  
 measurements in mm

View from above

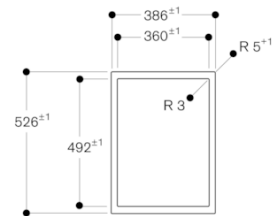

measurements in mm

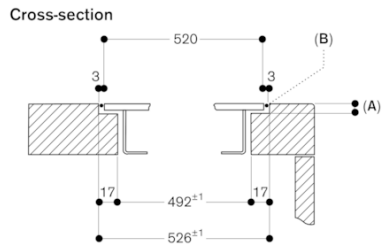

A: 3.5<sup>±0.5</sup>  
B: Fill with silicone  
measurements in mm